

Modellname:
Nazwa modelu:

LIBERO III Modellreihe: **89-358-31-7**
89-358-25-7

Numer modelu: **H1--L3**

Type: **31**
Typ:

Blatt Nr **1** von: **4**
Strona **1** z:

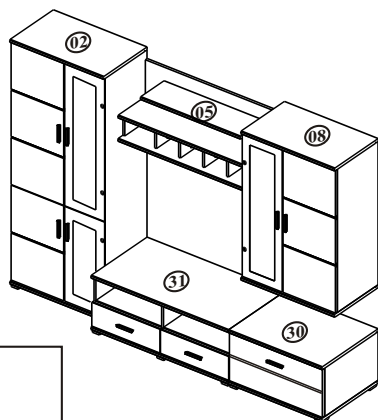

MONTAGEANLEITUNG INSTRUKCJA MONTAŻOWA

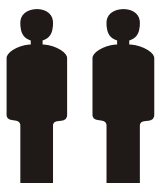

2 Personen
2 Osoby

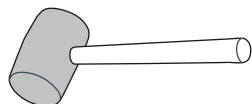
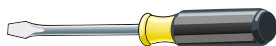
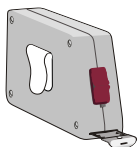

Max. zulässige Belastungen
von Einlegeböden in kg:
Maksymalne obciążenie półek w kg:

Länge/Di., mm	Stärke/Gr. Spanplatte/Płyta		
	15	18	22
0<400			
401<600	40	40	40
601<800	24		
801<1000	15	30	

Pflegehinweis!

Bitte nur mit einem Staubtuch oder einem feuchten Lappen reinigen.
KEINE scheuernde Putzmittel verwenden!

Wskazówka dotycząca pielęgnacji!

Proszę czyścić tylko suchą lub lekko wilgotną szmatką do kurzu. Nie używać żadnych środków szorstkich!

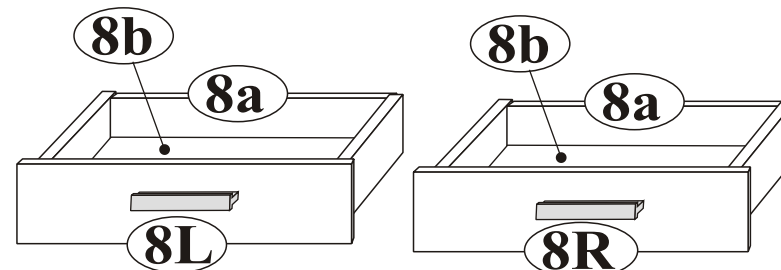
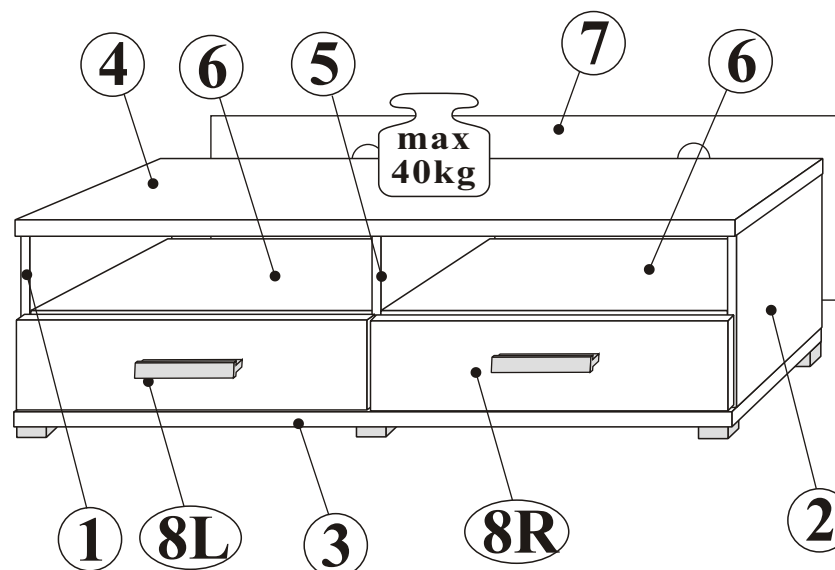

NR 1

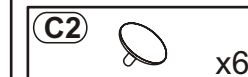
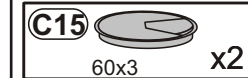
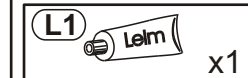
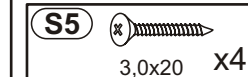
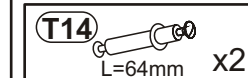
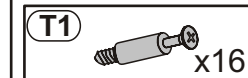
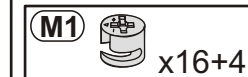
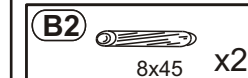
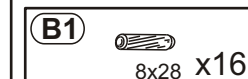

NR 2

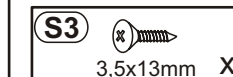
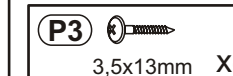
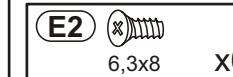
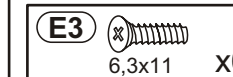
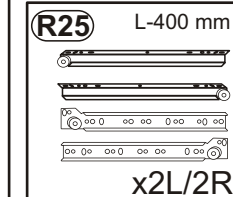

NR 3

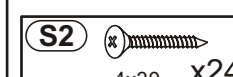

NR 4

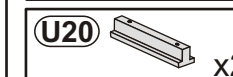
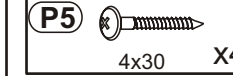

2

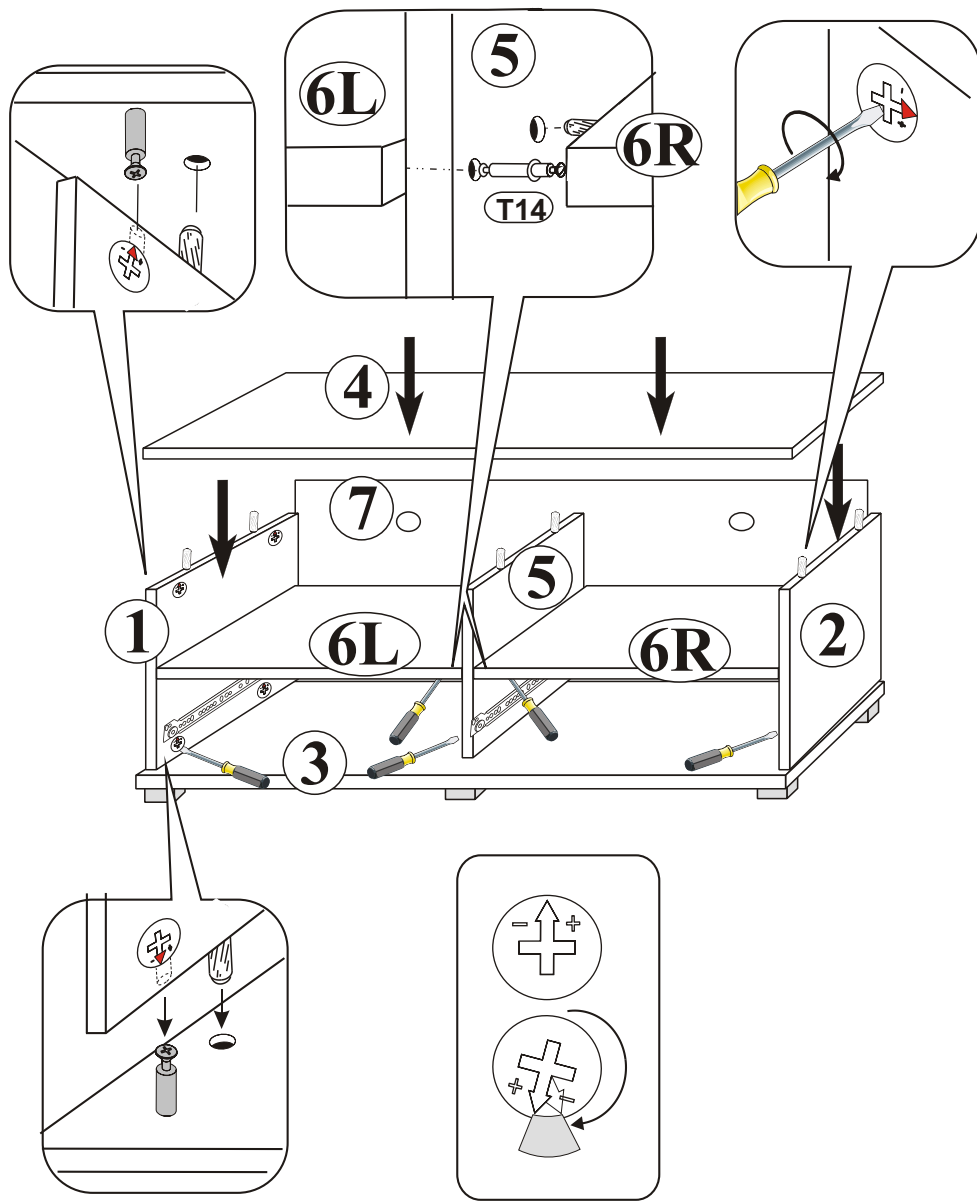
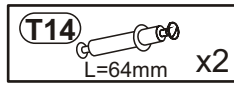

3

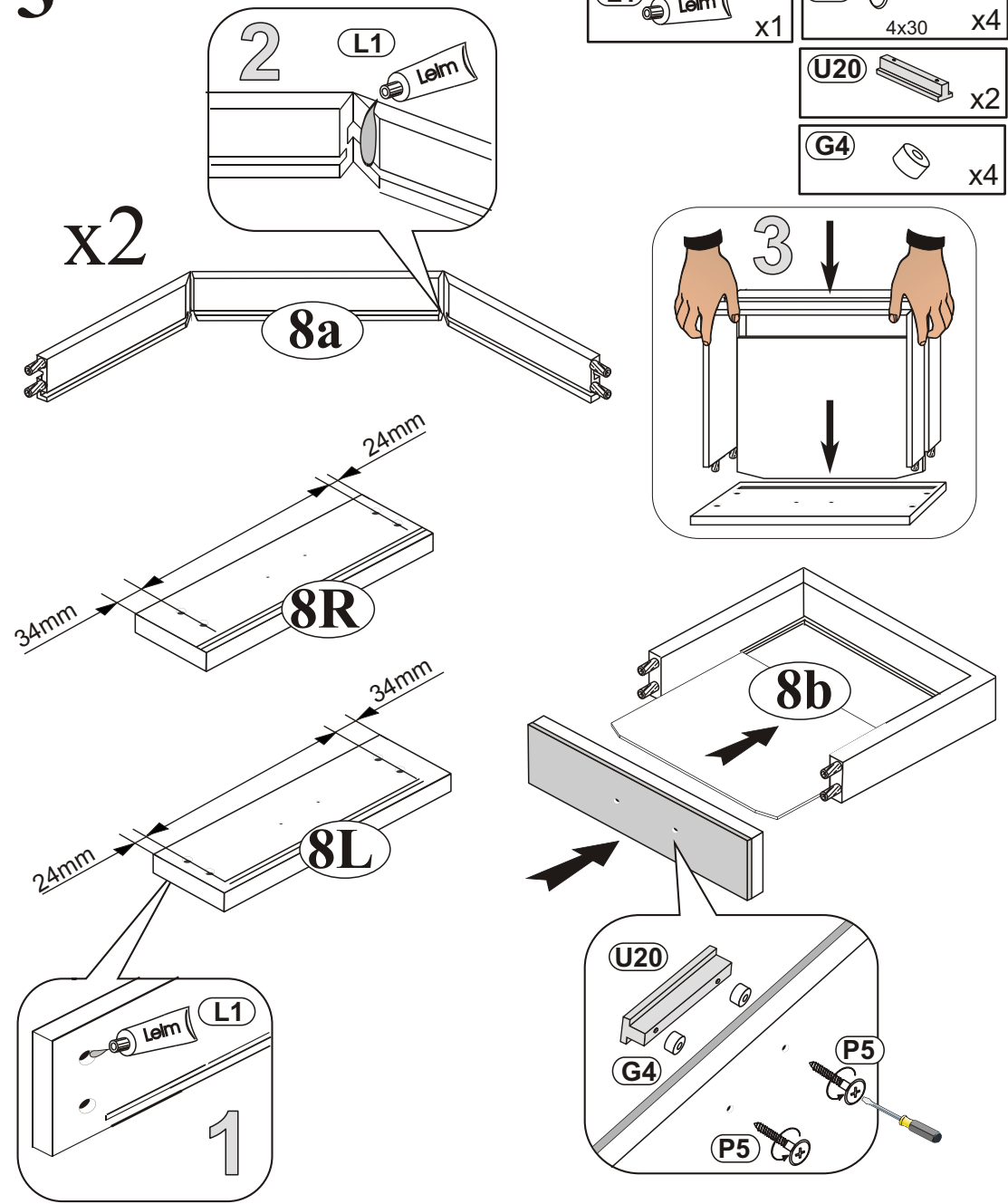
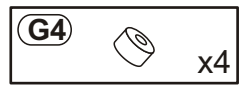
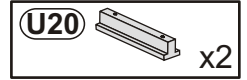
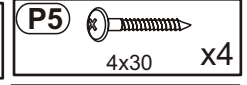
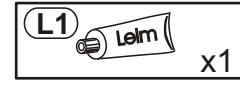

Modellname:
Nazwa modelu:

LIBERO III Modellreihe: **89-358-31-7**
89-358-25-7

Numer modelu: **H1--L3**

Type: **31**
Typ:

Blatt Nr **4** von: **4**
Strona z:

4

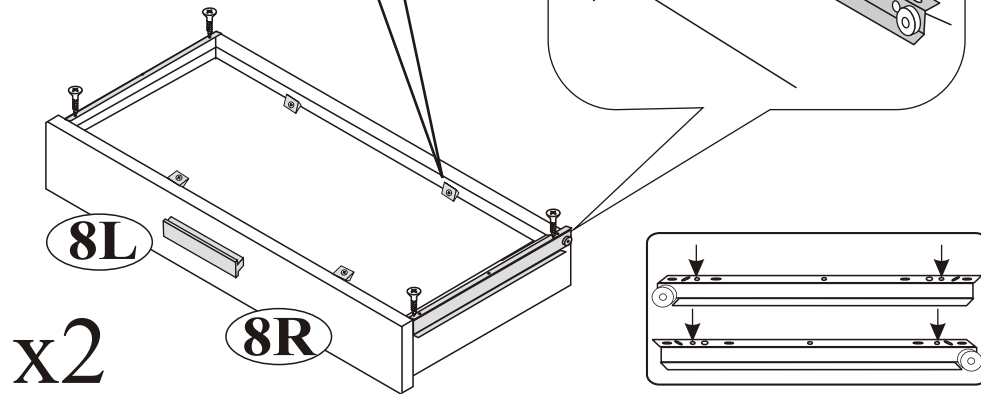
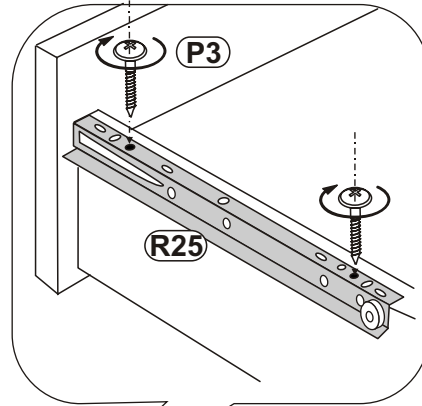
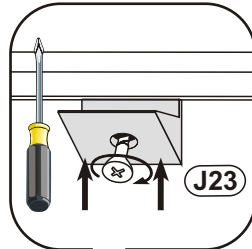
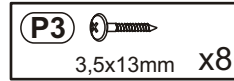
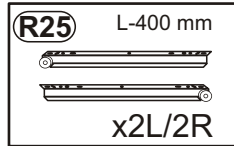

6

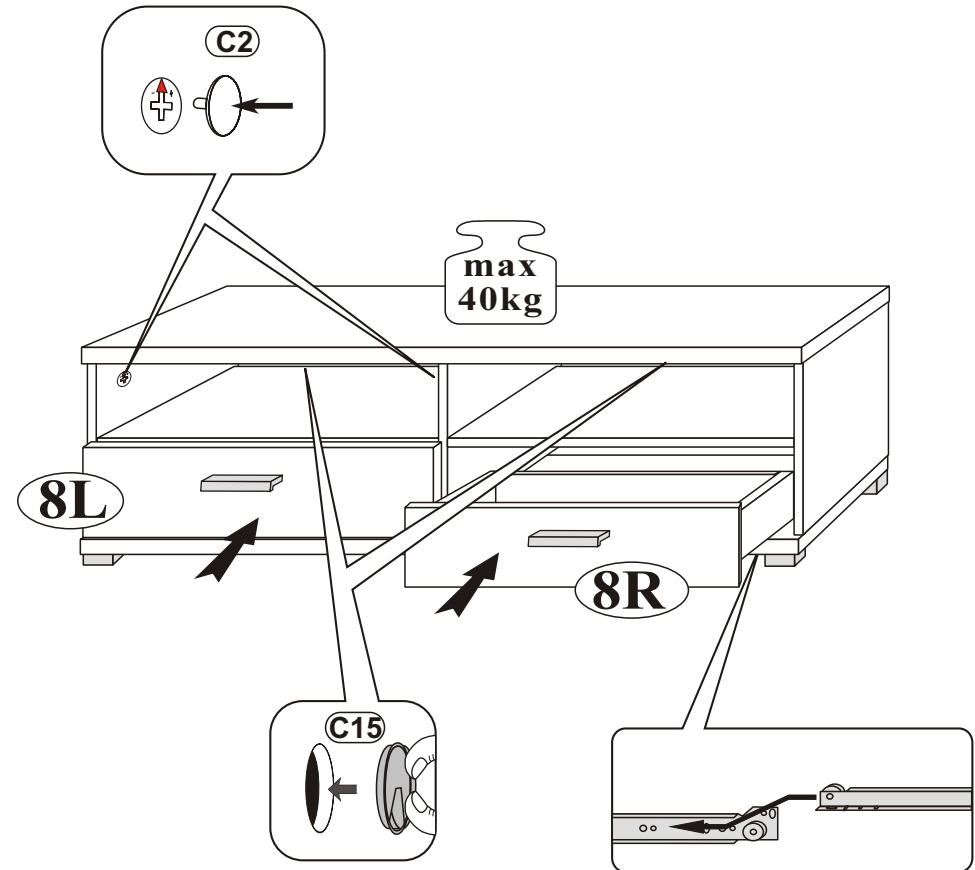
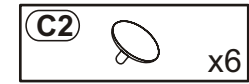
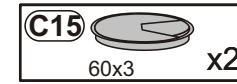

5

